

The Corporation of the District of North Cowichan

7030 Trans Canada Highway

P.O. Box 278, Duncan, BC

Building Department

Phone: 250-746-3100 Fax: 250-746-3154

BUILDING PERMIT

Permit #: **BP007658**

Folio: 01124-007

Issued Date: Jan 27, 2017

Permit Type: **SINGLE FAMILY DWELLING - NEW**

Description: THIS PERMIT HAS BEEN ISSUED FOR THE CONSTRUCTION OF A SINGLE FAMILY DWELLING

Address: **5900 STONEHAVEN DR**

Legal: LT 7 SEC 19 RGE 5 QUAM PL VIP89413

Zone: R3-S RESIDENTIAL SMALL L

P.I.D. 028-855-582

Applicant: THOMSON, BOB

Address: [REDACTED]

Phone: 250-710-5453

Owner: WEBB WORLD DEVELOPMENTS INC

Address: 3135 MANOR DR DUNCAN BC V9L 0A5

Phone:

Builder: THOMSON, BOB

Address: [REDACTED]

Phone: 250-710-5453

Description	Quantity	Amount	Description	Quantity	Amount
Bp Eng Driveway	1.00	25.00	Bp Eng Sweep	1.00	50.00
Bp Fees	208,488.00	1,809.42	Bp Fixtures	9.00	113.40
Bp Pl Sanitary	1.00	31.50	Bp Plumb Water	1.00	31.50
Covfee	0.00	1.00			

Total: \$2,061.82

Building Information:

TYPE OF IMPROVEMENT: NEW

FLOOR AREA RATIO (%): 0.5:1

CONSTRUCTION VALUE: 208,488.00

SITE COVERAGE (%): 39.8

Special Conditions:

- * The Municipality of North Cowichan will not be responsible for any errors, deficiencies and omissions in this plan information.
- * Neither the granting of a permit nor the approval of the relevant drawings and specifications nor the inspections made by the Municipality of North Cowichan shall in any way relieve the owner of such a building from full responsibility for the carrying out of work or having work carried out in full accordance with the requirements of the B.C.B.C. 2012
- * Plans have been reviewed for general conformance. It is the designers responsibility for accuracy, adequacy and all code requirements.
- *
- * Contractor shall be prime contractor while working within road right of way

OFFICE COPY

This permit expires and the right of an owner shall terminate, if the work is not commenced within 6 months, or if the work is not completed within 24 months of the date of issue of the permit. All Construction shall conform to the current edition of the B.C. Building Code and approved drawings issued with the Application For Permit For Erection, Alteration, or Repair of a Building. No deviation from these drawings, including site plans, shall be made without authorization being given subject to the same procedures established for the examination of the original plans.

The department reserves the right to reject any work which has been concealed or completed without first having been inspected and approved by the department in accordance with the requirements of the various codes.

Applicant: X

Building Inspector: TBYR

SCANNED

BUILDING PERMIT CERTIFICATE OF OCCUPANCY

August 9, 2017

Folio No. 01124-007
Permit No. BP007658

APPLICANT

THOMSON, BOB

ADDRESS

[REDACTED]

[REDACTED]

CIVIC ADDRESS: 5900 STONEHAVEN DR

This certifies that the premise described herein conforms substantially to the approved plans and specifications and to the requirements of all applicable laws, rules and regulations for the uses and occupancies specified. No change of use or occupancy shall be made unless a new Certificate of Occupancy is issued.

Building Inspector: Tim Byron

THIS IS
NOT A CERTIFIED COPY
PROVIDED FOR
CONVENIENCE USE ONLY

This Information has been provided
subject to the federal *Copyright Act*
and in accordance with the provincial
*Freedom of Information and
Protection of Privacy Act.*

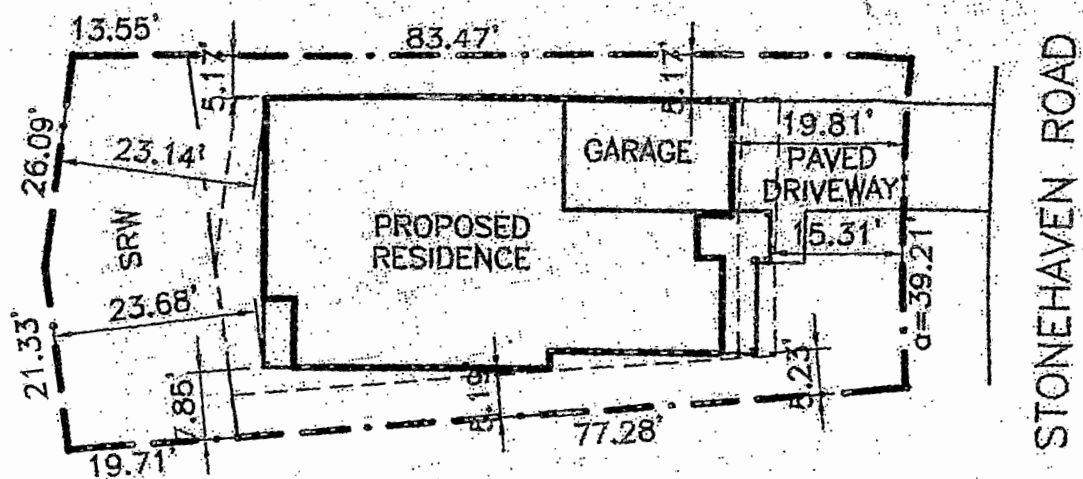

SITE PLAN
SCALE: 1"=20'-0"

THE CORPORATION OF THE OF THE DISTRICT OF NORTH COWICHAN

FOLIO No.		LEGAL	LOT	BLK	RGE	SEC	PLAN	DIST	ADDRESS	
	01124-007	7		-	5	19	89413	Quamichan	5900 Stonehaven Drive	
METER SERIAL No.	WATER City Of Duncan	SEWER		DRAIN			GAS		HYDRO/TEL	
INSTALLATION DATE	FALL 2011	FALL 2011		FALL 2011			FALL 2011		FALL 2011	
SIZE OF SERVICE	20 mm dia	100 mm dia		100 mm dia						
TYPE OF SERVICE	Poly	PVC		PVC					PVC – U/G	
CONNECTION LENGTH	4.2 m	7.5		10.5						
METER SIZE AND TYPE	20 mm Rockwell									
DEPTH AT PL	0.5	1.3		1.3						
DEPTH AT MAIN	1.0	3.2		1.8						
LOCATION AT PL	6.8m South Of North P/L	3.2m South Of North P/L		2.8m South Of North P/L					1.3m Sourth Of NE IP	
LOCATION AT MAIN										
REVISION/DATE										
COMMENTS										
PRIOR TO EXCAVATING, CONTACT GAS, HYDRO, TELEPHONE, AND CABLE TO CONFIRM LOCATIONS						THE MUNICIPALITY ASSUMES NO RESPONSIBILITY FOR THE ACCURACY OF THE INFORMATION CONTAINED ON THIS SERVICE RECORD.				

